

# ULTRA

## Muti-Fan Controller Installation Guide

### STEP 1



Install the Multi-Fan Controller to 3.5" drive bay.

### STEP 2



Affix the Multi-Fan Controller.

### STEP 3

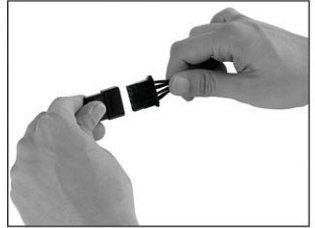

Connect the 4 pin power connector to power supply connector.

### STEP 4



Connect case fan cable with Multi-Fan Controller

### STEP 5

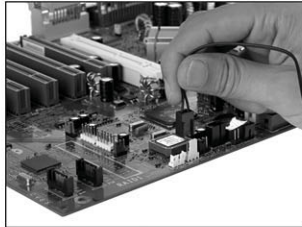

Connect the fan monitor cable to motherboard.

### STEP 6



Adjust fan speed

樣本